

Side Clamps NU/FL/SK/SKO

NU has a clamping force up to 18 kN.
These side clamps are perfect for low profile free surface machining. They are generally used on milling machines in metal cutting.

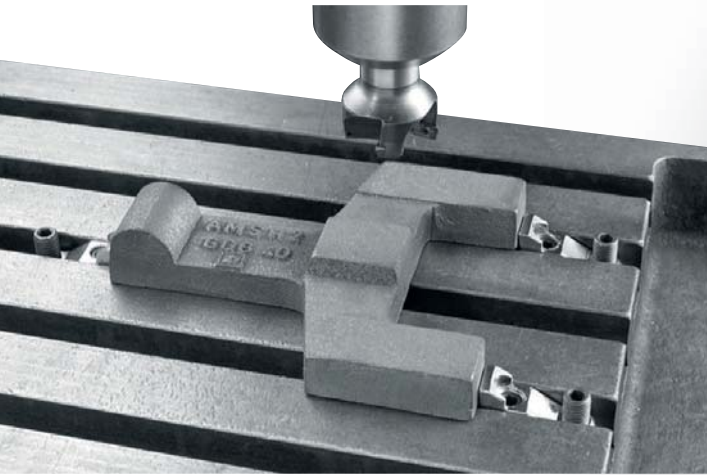

FL has a clamping force up to 40 kN.
These side clamps are perfect for low profile free surface machining. They are generally used on milling machines in metal cutting.

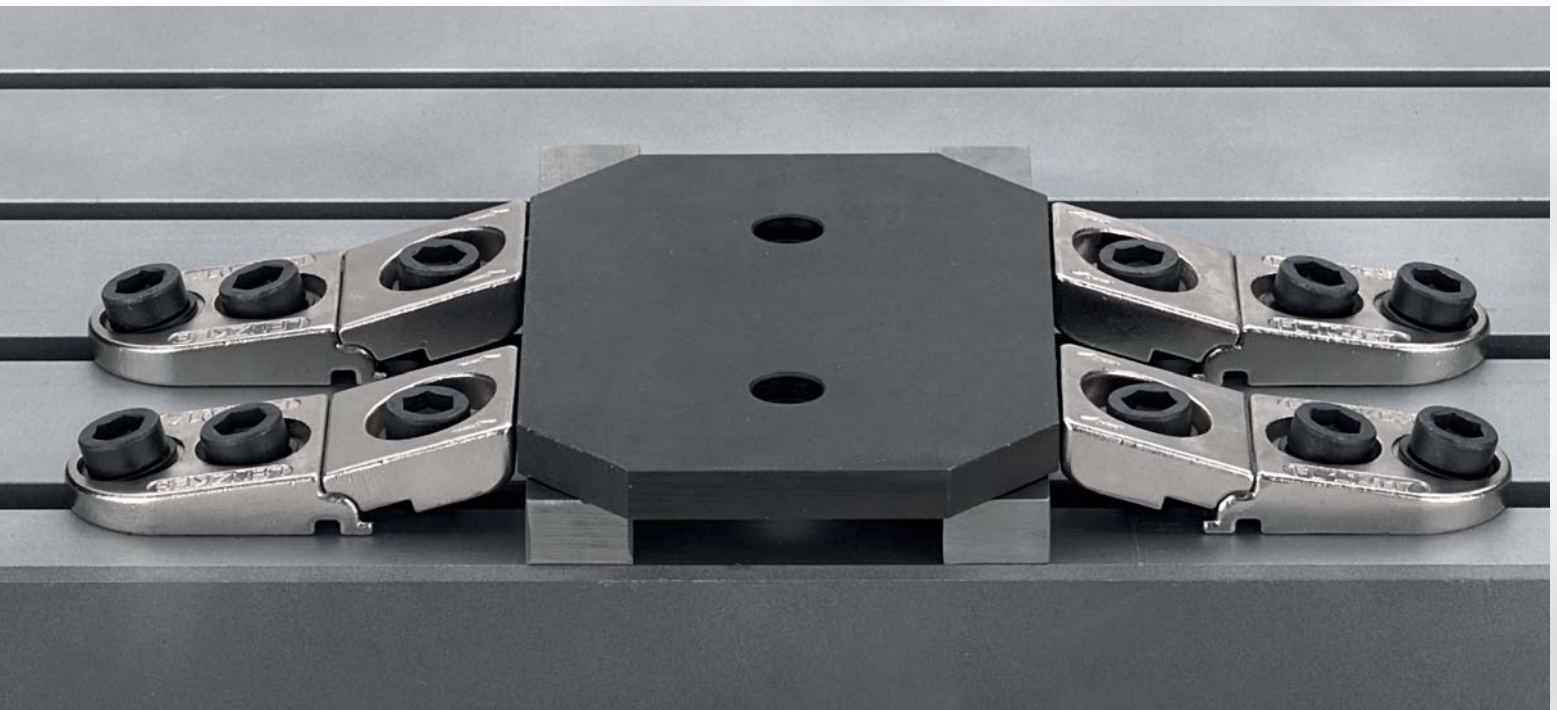

SK/SKQ has a clamping force up to 65 kN.

These side clamps are ideal for free surface machining and generate great clamping force. The SKQ can be used at an angle to the T-Slot or parallel to the T-Slot. They are generally used on milling machines in metal cutting.

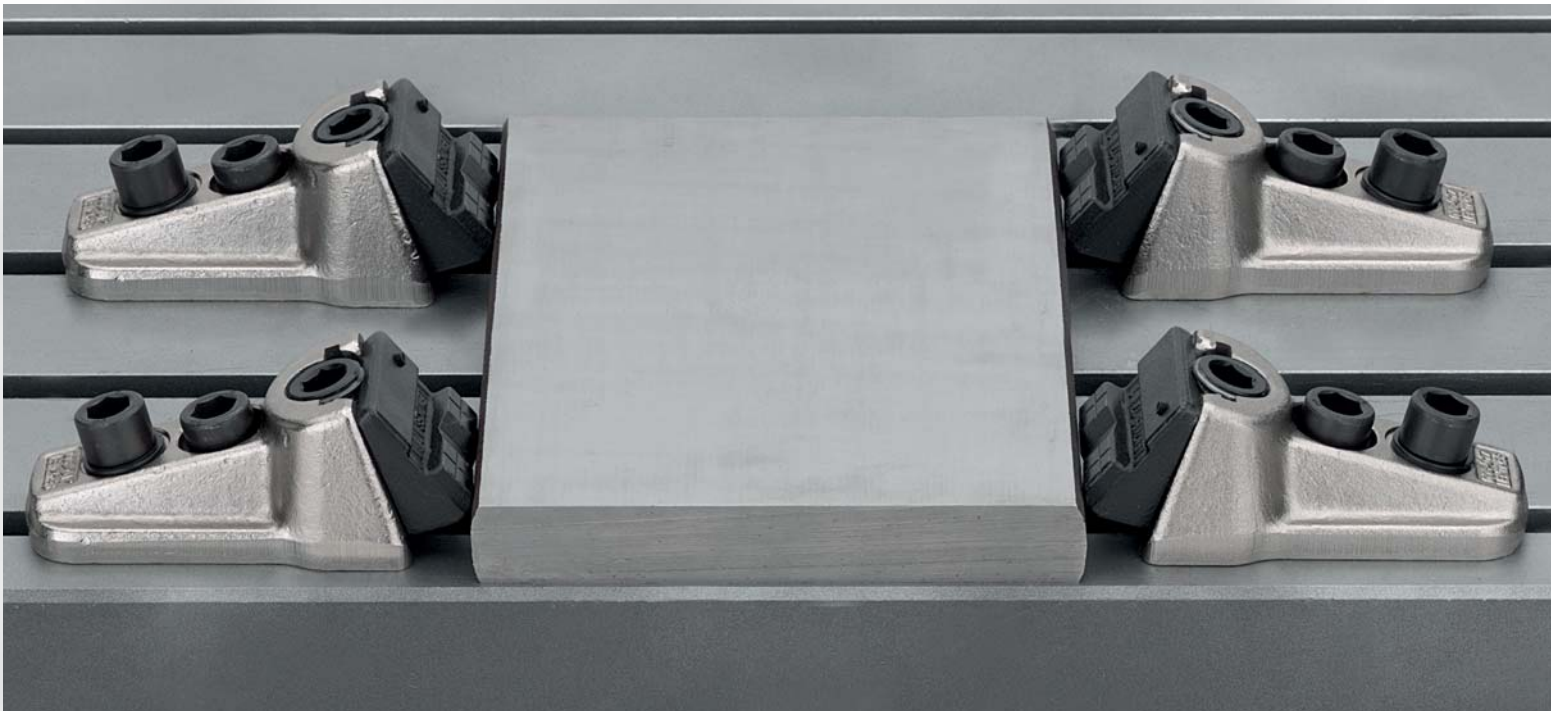
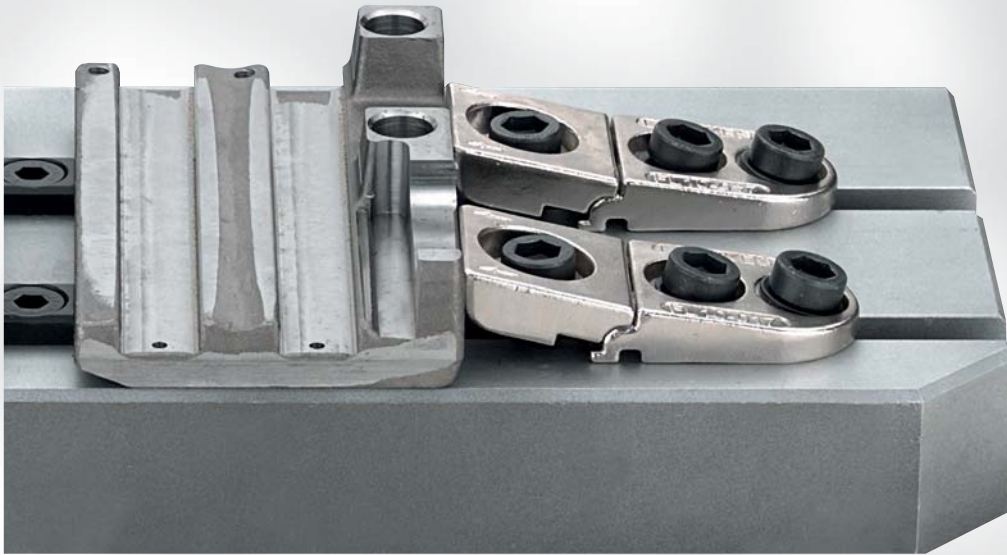

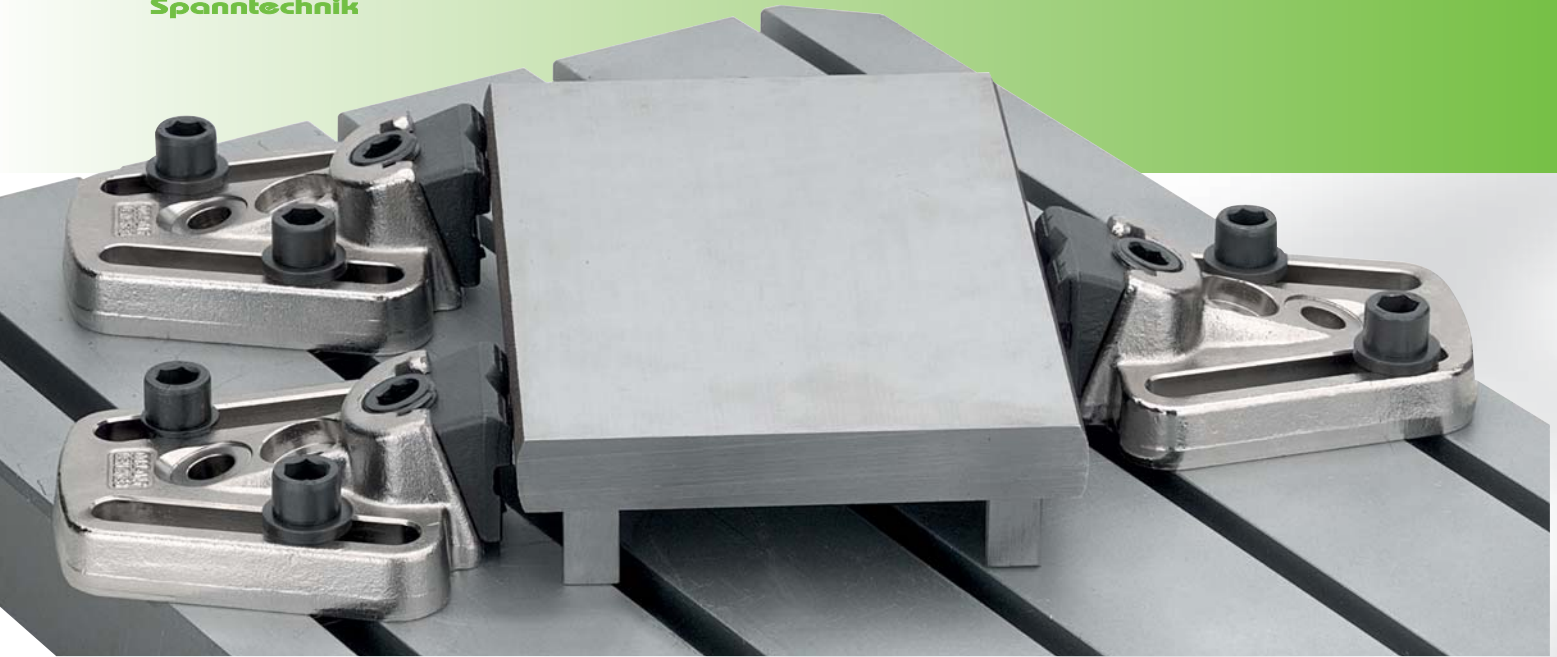

Self Centering Clamp has a clamping force up to 25 kN.
These self centering clamps are stepless adjustable.
Base plate with centered tapped hole.



Application Example:
Metal cutting

- For free surface machining
- For low profile workpieces

Side Clamps
NU 10 (complete)

■ Material: Hardened alloy steel

Clamping Force: **Up to 18 kN**

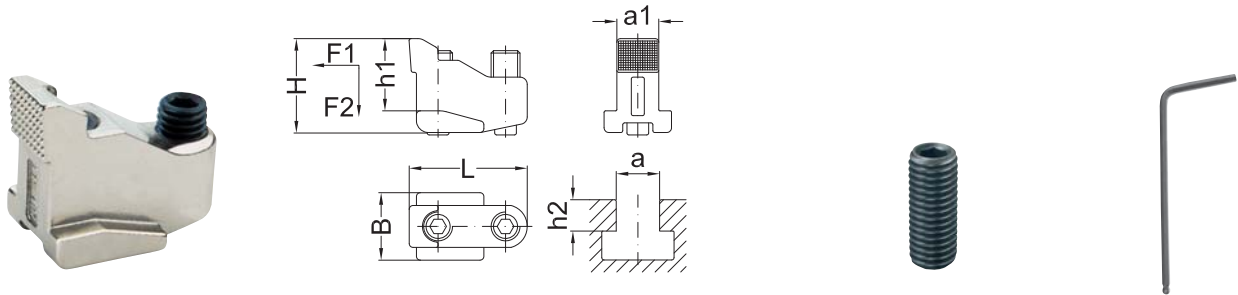

									kN	kN	Fixing Screw			Allen Key	
H	a	Part No.		B	L	a1	h1	h2	F1	F2	Part No.		L	Part No.	
25	10	002-0810		15	27	9,7	20	10-14	5,0	2,5	913-06-020		20	612-03	
27	12	002-1012		18	33	11,6	21	12-17	6,0	3,0	913-08-020		20	612-04	
31	14	002-1214		22	40	13,6	24	14-19	7,0	3,5	913-10-025		25	612-05	
35	16	002-1416		25	46	15,5	27	16-22	8,0	4,0	913-12-030		30	610-06	
39	18	002-1618		28	49	17,4	30	18-24	10,0	5,0	913-12-030		30	610-06	
50	22	002-2022		35	63	21,5	37	22-30	16,0	8,0	913-16-040		40	610-08	
62	28	002-2428		44	79	27,4	46	28-36	18,0	9,0	913-20-050		50	610-10	

NU Side Clamp with Ball Pressure Screw
(helps to protect the T-Slots)

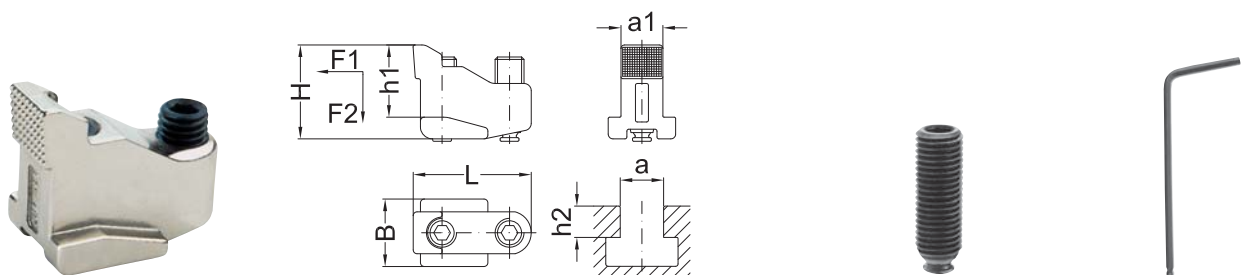

									kN	kN	Ball Pressure Screw			Allen Key	
H	a	Part No.		B	L	a1	h1	h2	F1	F2	Part No.		L	Part No.	
27	12	002-1012-1		18	33	11,6	21	12-17	6,0	3,0	309-08-020		20	612-04	
31	14	002-1214-1		22	40	13,6	24	14-19	7,0	3,5	309-10-025		25	612-05	
35	16	002-1416-1		25	46	15,5	27	16-22	8,0	4,0	309-12-030		30	610-06	
39	18	002-1618-1		28	49	17,4	30	18-24	10,0	5,0	309-12-030		30	610-06	
50	22	002-2022-1		35	63	21,5	37	22-30	16,0	8,0	309-16-040		40	610-08	
62	28	002-2428-1		44	79	27,4	46	28-36	18,0	9,0	309-20-050		50	610-10	

Side Clamps
FL10 (complete)

Application Example:
Metal cutting

- For free surface machining
- Low profile side clamp
- Drop forged alloy steel increases life span of the clamp

Clamping Force: **Up to 40 kN**

- **Material: Hardened alloy steel**

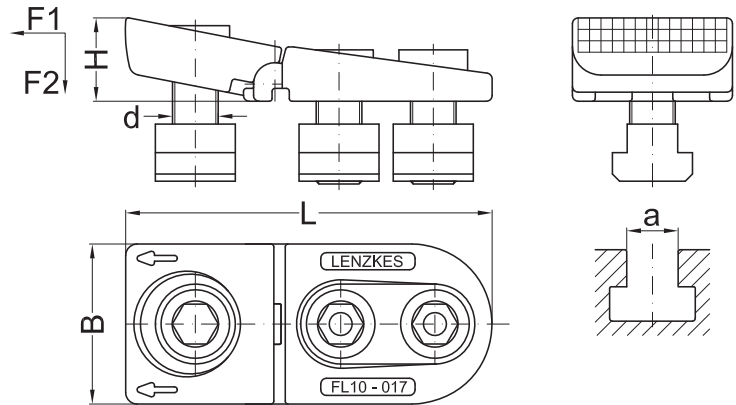

							kN	kN
H	d	a	Part No.		B	L	F1	F2
22-14	-	-	004-09		34	90	-	-
	M06	8	004-09-0608				4,0	2,0
	M08	10	004-09-0810				7,0	3,5
	M08	12	004-09-0812				7,0	3,5
25-17	-	-	004-13		44	112	-	-
	M08	10	004-13-0810				7,0	3,5
	M10	12	004-13-1012				10,0	5,0
	M12	14	004-13-1214				15,0	7,5
	M12	16	004-13-1216				15,0	7,5
30-20	-	-	004-17		56	132	-	-
	M12	14	004-17-1214				15,0	7,5
	M14	16	004-17-1416				20,0	10,0
	M16	18	004-17-1618				25,0	12,5
	M16	20	004-17-1620				25,0	12,5
	M16	22	004-17-1622				25,0	12,5
35-24	-	-	004-21		62	155	-	-
	M16	18	004-21-1618				25,0	12,5
	M18	20	004-21-1820				30,0	15,0
	M20	22	004-21-2022				36,0	18,0
	M20	24	004-21-2024				36,0	18,0
	M20	28	004-21-2028				36,0	18,0

Side Clamps FL10 (Spare Parts)

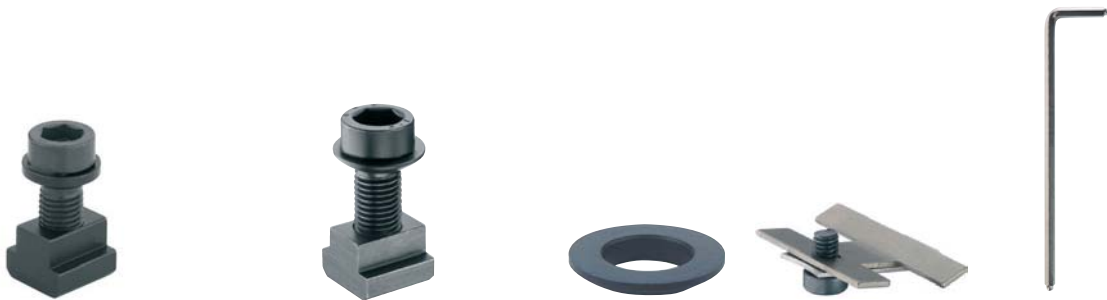

Fixing Set front with Spherical Seat Washer			Fixing Set rear complete (2 pcs with Washer)				Spherical Seat Washer		Spring with Screw		Allen Key 	
Part No.		L	Part No.		L	S	Part No.		Part No.		Part No.	
-		-	-		-	-	-		360-004-09		-	
904-109-0608		20	904-409-0608		20	5	319-108				612-05	
904-109-0810		22	904-409-0810		22	6					611-06	
904-109-0812		25	904-409-0812		25							
-		-	-		-	-	-		360-004-13		-	
904-113-0810		25	904-413-0810		25	6	319-004-12				611-06	
904-113-1012		25	904-413-1012		25	8					611-08	
904-113-1214		30	904-413-1214		30	10					611-10	
904-113-1216		35	904-413-1216		35							
-		-	-		-	-	-		360-004-17		-	
904-117-1214		30	904-417-1214		30	10	319-004-16				611-10	
904-117-1416		35	904-417-1416		35	12					611-12	
904-117-1618		35	904-417-1618		35	14					611-14	
904-117-1620		40	904-417-1620		40							
904-117-1622		45	904-417-1622		45							
-		-	-		-	-	-		360-004-21		-	
904-121-1618		40	904-421-1618		40	14	319-004-20				611-14	
904-121-1820		45	904-421-1820		45							
904-121-2022		50	904-421-2022		50	17					611-17	
904-121-2024		55	904-421-2024		55							
904-121-2028		60	904-421-2028		60							



Side Clamps
FL10 (complete)

Application Example:
Metal cutting

- For free surface machining
- Low profile side clamp
- Drop forged alloy steel increases life span of the clamp

Clamping Force: **Up to 40 kN**

- **Material: Hardened alloy steel**
- **Set-up time is considerably reduced due to long T-Nut**
- **New design generates increased clamping force**

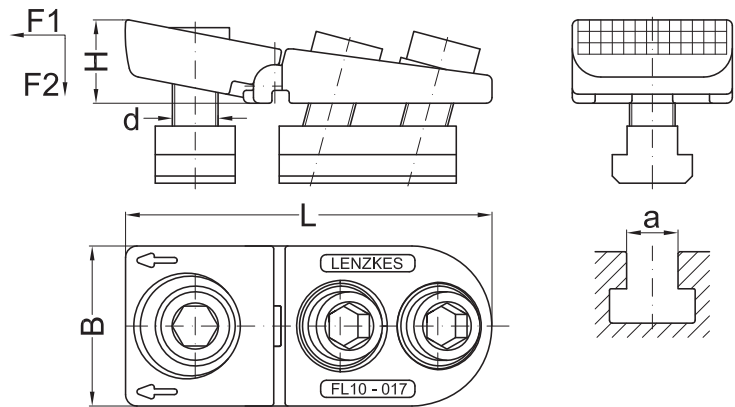

							kN	kN
H	d	a	Part No.		B	L	F1	F2
22-14	-	-	004-09		34	90	10,0	5,0
	M06	8	004-09-0608-2					
	M08	10	004-09-0810-2					
	M08	12	004-09-0812-2					
25-17	-	-	004-013		44	112	20,0	10,0
	M08	10	004-013-0810					
	M10	12	004-013-1012					
	M12	14	004-013-1214					
	M12	16	004-013-1216					
	M12	18	004-013-1218					
30-20	-	-	004-017		56	132	28,0	14,0
	M12	14	004-017-1214					
	M14	16	004-017-1416					
	M16	18	004-017-1618					
	M16	20	004-017-1620					
	M16	22	004-017-1622					
35-24	-	-	004-021		62	155	40,0	20,0
	M16	18	004-021-1618					
	M18	20	004-021-1820					
	M20	22	004-021-2022					
	M20	24	004-021-2024					
	M20	28	004-021-2028					

Side Clamps FL 10 (Spare Parts)



Fixing Set front with Spherical Seat Washer			Fixing Set rear				Spherical Seat Washer		Spring with Screw		Allen Key 	
Part No.		L	Part No.		L	S	Part No.		Part No.		Part No.	
-		-	-		-	-	-		360-004-09		-	
904-109-0608		20	904-309-0608		20	5	319-108				612-05	
904-109-0810		22	904-309-0810		22	6					611-06	
904-109-0812		25	904-309-0812		25							
-		-	-		-	-	-		360-004-13		-	
904-113-0810		25	904-213-0810		25	6	319-004-12				611-06	
904-113-1012		25	904-213-1012		25	8					611-08	
904-113-1214		30	904-213-1214		30	10					611-10	
904-113-1216		35	904-213-1216		35							
904-113-1218		35	904-213-1218		35							
-		-	-		-	-		-		360-004-17		-
904-117-1214		30	904-217-1214		30	10	319-004-16				611-10	
904-117-1416		35	904-217-1416		35	12					611-12	
904-117-1618		35	904-217-1618		35	14					611-14	
904-117-1620		40	904-217-1620		40							
904-117-1622		45	904-217-1622		45							
-		-	-		-	-		-		360-004-21		-
904-121-1618		40	904-221-1618		40	14	319-004-20				611-14	
904-121-1820		45	904-221-1820		45							
904-121-2022		50	904-221-2022		50	17					611-17	
904-121-2024		55	904-221-2024		55							
904-121-2028		60	904-221-2028		60							



Side Clamps SK10 (complete)

Application Example: Metal cutting

- For free surface machining, can be used parallel to the T-Slot
- Drop forged alloy steel increases life span of the clamp

Clamping Force: **Up to 65 kN**

- **Material:** Drop forged alloy steel
- **Set-up time** is considerably reduced due to long T-Nut design
- **New design** generates increased clamping force

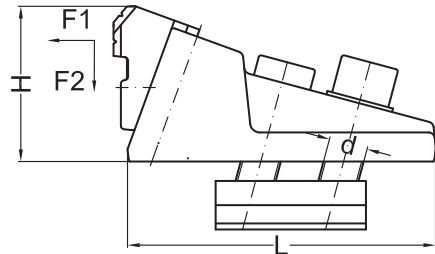
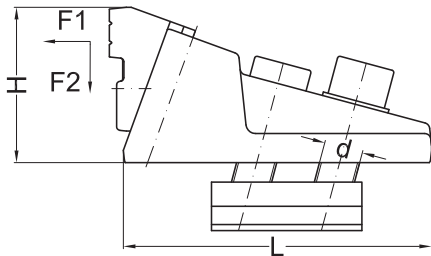

				with Standard Face		with Reversible Face					kN	kN
H	h	d	a	Part No.		Part No.		b	B	L	F1	F2
40-50	17-27	-	-	006-013-1		006-013-2		50	58	100	20	10
		M08	10	006-013-1-0810		006-013-2-0810						
		M10	12	006-013-1-1012		006-013-2-1012						
		M12	14	006-013-1-1214		006-013-2-1214						
		M12	16	006-013-1-1216		006-013-2-1216						
		M12	18	006-013-1-1218		006-013-2-1218						
51-64	20-33	-	-	006-017-1		006-017-2		60	70	127	25	12
		M12	14	006-017-1-1214		006-017-2-1214						
		M14	16	006-017-1-1416		006-017-2-1416						
		M16	18	006-017-1-1618		006-017-2-1618						
		M16	20	006-017-1-1620		006-017-2-1620						
		M16	22	006-017-1-1622		006-017-2-1622						
76-93	28-45	-	-	006-021-1		006-021-2		80	95	167	40	20
		M16	18	006-021-1-1618		006-021-2-1618						
		M18	20	006-021-1-1820		006-021-2-1820						
		M20	22	006-021-1-2022		006-021-2-2022						
		M20	24	006-021-1-2024		006-021-2-2024						
		M20	28	006-021-1-2028		006-021-2-2028						
110-128	37-55	-	-	006-025-1		006-025-2		92	113	210	65	32
		M20	22	006-025-1-2022		006-025-2-2022						
		M22	24	006-025-1-2224		006-025-2-2224						
		M24	28	006-025-1-2428		006-025-2-2428						
		M24	36	006-025-1-2436		006-025-2-2436						

Side Clamps SK10 (Spare Parts)

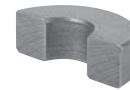
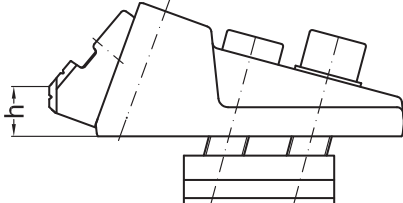
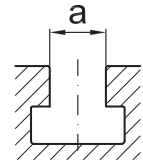
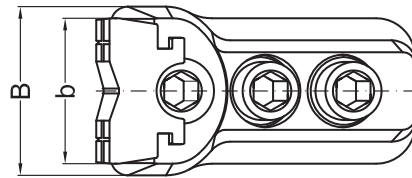

Fixing Set long			Driving Ring			Retaining Ring		Allen Key	
Part No.		L	Part No.		s	Part No.		Part No.	
-		-	009-013-1-10		8	009-13-2		610-08	
907-213-0810		35	009-013-1-08		6			610-06	
907-213-1012		35	009-013-1-10		8			610-08	
907-213-1214		40	009-013-1-12		10			610-10	
907-213-1216		45							
907-213-1218		45							
-		-	009-017-1-14		12	009-17-2		610-12	
907-217-1214		45	009-017-1-12		10			610-10	
907-217-1416		50	009-017-1-14		12			610-12	
907-217-1618		50	009-017-1-16		14			610-14	
907-217-1620		55							
907-217-1622		60							
-		-	009-021-1-18		14	009-21-2		610-14	
907-221-1618		60							
907-221-1820		60							
907-221-2022		65	009-021-1-20		17			610-17	
907-221-2024		70							
907-221-2028		75							
-		-	009-025-1-22		17	009-25-2		610-17	
907-225-2022		80							
907-225-2224		85							
907-225-2428		90	009-025-1-24		19			612-19	
907-225-2436		100							

Side Clamps
SKQ 10 (complete)

Application Example:
Metal cutting

- For free surface machining
- Can be used parallel or at an angle to the T-Slot
- Drop forged alloy steel increases life span of the clamp

Clamping Force: **Up to 65 kN**

- **Material:** Drop forged alloy steel
- **The unique design of the clamp allows work-pieces to be clamped at any angle to the T-Slot**
- **New design generates increased clamping force**

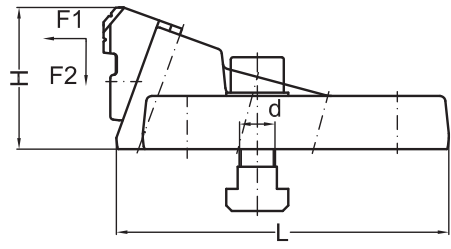
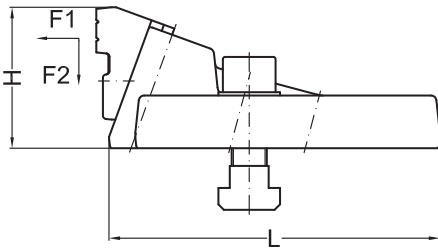

				with Standard Face		with Reversible Face						kN	kN
H	h	d	a	Part No.		Part No.		b	B	L	L1	F1	F2
40-50	17-27	-	-	008-013-1		008-013-2		50	126	132	82	20	10
		M08	10	008-013-1-0810		008-013-2-0810							
		M10	12	008-013-1-1012		008-013-2-1012							
		M12	14	008-013-1-1214		008-013-2-1214							
		M12	16	008-013-1-1216		008-013-2-1216							
		M12	18	008-013-1-1218		008-013-2-1218							
51-64	20-33	-	-	008-017-1		008-017-2		60	144	150	95	25	12
		M12	14	008-017-1-1214		008-017-2-1214							
		M14	16	008-017-1-1416		008-017-2-1416							
		M16	18	008-017-1-1618		008-017-2-1618							
		M16	20	008-017-1-1620		008-017-2-1620							
		M16	22	008-017-1-1622		008-017-2-1622							
76-93	28-45	-	-	008-021-1		008-021-2		80	182	194	120	40	20
		M16	18	008-021-1-1618		008-021-2-1618							
		M18	20	008-021-1-1820		008-021-2-1820							
		M20	22	008-021-1-2022		008-021-2-2022							
		M20	24	008-021-1-2024		008-021-2-2024							
		M20	28	008-021-1-2028		008-021-2-2028							
110-128	37-55	-	-	008-025-1		008-025-2		92	248	257	160	65	32
		M20	22	008-025-1-2022		008-025-2-2022							
		M22	24	008-025-1-2224		008-025-2-2224							
		M24	28	008-025-1-2428		008-025-2-2428							
		M24	36	008-025-1-2436		008-025-2-2436							

Side Clamps SKO 10 (Spare Parts)

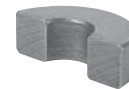
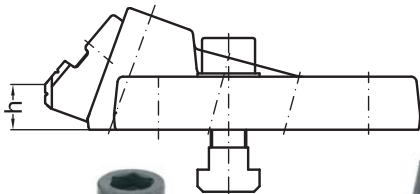
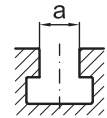
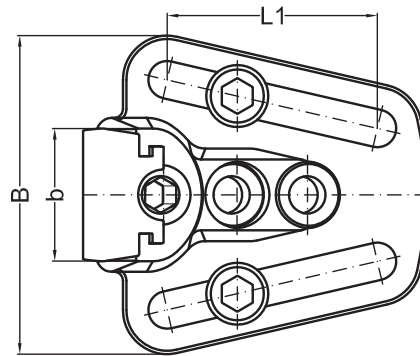

Fixing Set for SKO			Fixing Set long T-Nut for SK/SKO			Driving Ring			Retaining Ring		Allen Key				
Part No.		L	Part No.		L	Part No.		s	Part No.		Part No.				
-		-	-		-	009-013-1-10		8	009-13-2		610-08				
907-113-0810		35	907-213-0810		35	009-013-1-08		6				610-06			
907-113-1012		35	907-213-1012		35	009-013-1-10		8				610-08			
907-113-1214		40	907-213-1214		40	009-013-1-12		10			610-10				
907-113-1216		45	907-213-1216		45										
907-113-1218		50	907-213-1218		45										
-		-	-		-	009-017-1-14		12	009-17-2		610-12				
907-117-1214		45	907-217-1214		45	009-017-1-12		10				610-10			
907-117-1416		50	907-217-1416		50	009-017-1-14		12				610-12			
907-117-1618		50	907-217-1618		50	009-017-1-16		14				610-14			
907-117-1620		55	907-217-1620		55										
907-117-1622		60	907-217-1622		60										
-		-	-		-	009-021-1-18		14	009-21-2		610-14				
907-121-1618		60	907-221-1618		60	009-021-1-20		17				610-17			
907-121-1820		60	907-221-1820		60										
907-121-2022		65	907-221-2022		65										
907-121-2024		70	907-221-2024		70	009-025-1-22		17	009-25-2		610-17				
907-121-2028		75	907-221-2028		75										
-		-	-		-										
907-125-2022		80	907-225-2022		80	009-025-1-24		19			612-19				
907-125-2224		85	907-225-2224		85										
907-125-2428		90	907-225-2428		90										
907-125-2436		100	907-225-2436		100										

