

# X-CLAMP 100 XXL

ORDER NUMBER: 0020.1071

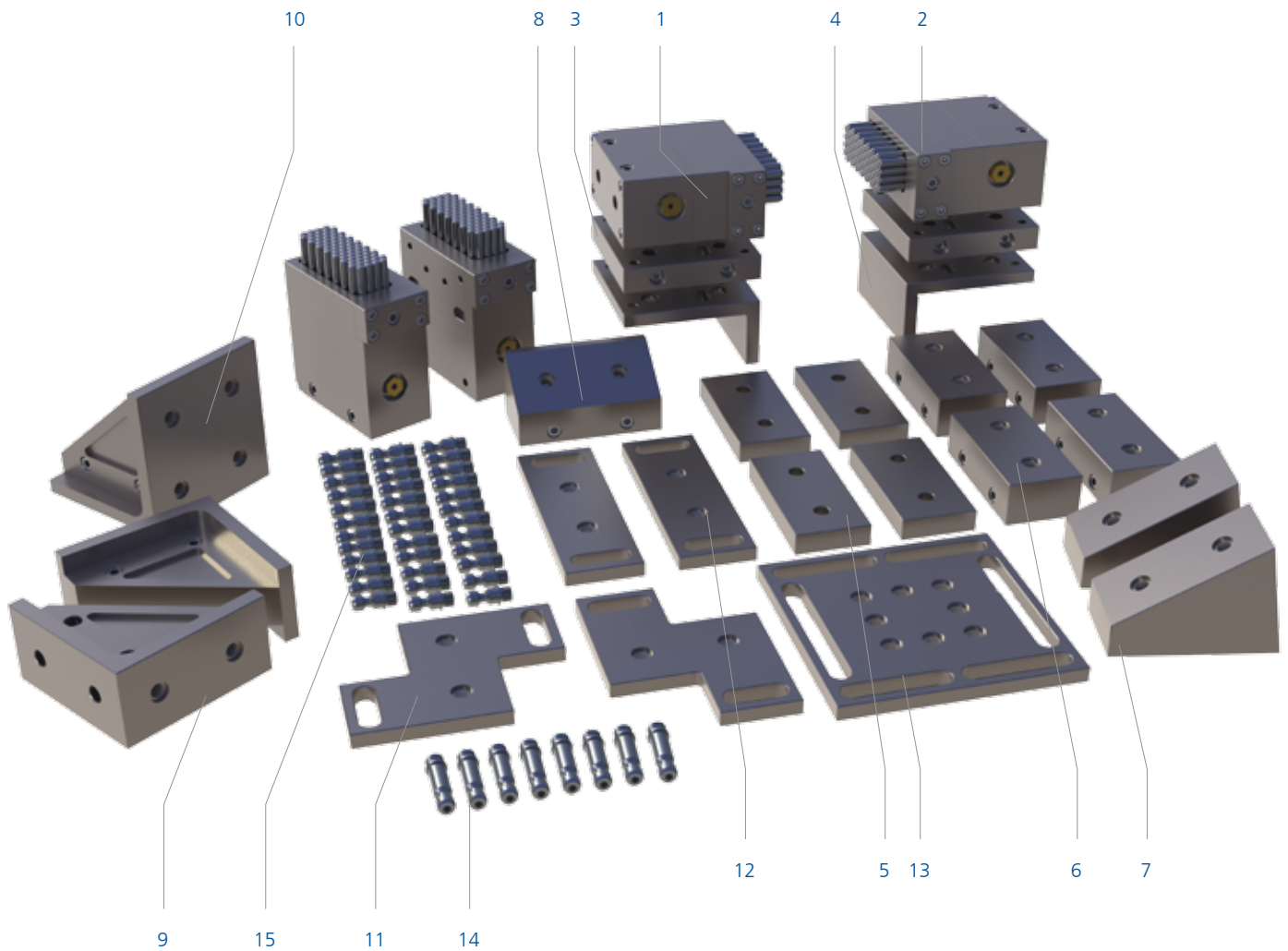

## **X-CLAMP** 100 XXL

The X-CLAMP 100 XXL is the logical and comprehensive extension for a multitude of applications. With the SILVER CLAMP system MATRIX® offers fast solutions for mold clamping. The option of using the modules as mold jaw and as support elements is revolutionary. Your vise can be easily transformed into a support system for complexly shaped workpieces. The result: You always have the correct jig for every workpiece.



The modular system consists of the following individual components:

Fig.	Article no.	Quantity	Description	Dimension	Pin field	Number of pins	Pin diameter	Pin stroke
1	0020.1067	2	X-CLAMP 100 L Module	50 x 105 x 100 mm	30 x 80 mm	67 Pieces	6 mm	21 mm
			Further information about the module:	Weight: 3.1 kg, Material housing/pins: Stainless steel, Installation location: any, Cleaning: Air and coolant connections, Data sheet and CAD data on request				
2	0021.1067	2	X-CLAMP 100 R Module	50 x 105 x 100 mm	30 x 80 mm	67 Pieces	6 mm	21 mm
			Further information about the module:	Data mirror-image identical to module X-CLAMP 100L, Weight: 3.1 kg, Material housing/pins: Stainless steel, Installation location: any, Cleaning: Air and coolant connections, Data sheet and CAD data on request				
3	0020.1026	2	Adapter plate for X-CLAMP 100	100 x 100 x 18,5 mm	–	–	–	–
4	0020.1039	2	Adapter angle	100 x 100 x 50 mm (Fastening bores optional)	–	–	–	–
5	0020.1015	4	Adapter for X-CLAMP 100	50 x 100 x 15 mm	–	–	–	–
6	0020.1016	4	Adapter for X-CLAMP 100	50 x 10 x 30 mm	–	–	–	–
7	0020.1030	2	Angle for X-CLAMP 100	30°, 50 x 100 mm	–	–	–	–
8	0020.1031	1	Angle for X-CLAMP 100	30°, 100 x 50 mm	–	–	–	–
9	0020.1035	2	Angle with sup- porting strut for X-CLAMP 100	50 x 100 x 100 mm	–	–	–	–
10	0020.1036	1	Angle with two sup- porting struts for X-CLAMP 100	100 x 100 x 100 mm	–	–	–	–
11	0020.0120	2	S-Base plate for X-CLAMP 100	130 x 100 x 10 mm	–	–	–	–
12	0020.0100	2	Base plate for X-CLAMP 100	50 x 150 x 10 mm	–	–	–	–
13	0020.0150	1	Double baseplate for X-CLAMP 100	150 x 150 x 10 mm	–	–	–	–
14	0020.0042	8	Connection pin for X-CLAMP	M10 x 42 mm	–	–	–	–
15	0020.0027	36	Connection pin for X-CLAMP	M10 x 27 mm	–	–	–	–
16	–	1	Torque wrench	–	–	–	–	–
–	–	1	Hex wrenches (set)	–	–	–	–	–
17	0900.9000	2	MATRIX case	–	–	–	–	–